

INNER PORTLAND INFILL SITE

NEW HOMES AROUND A HAPPY COMMUNAL SPACE

Dwelling in a relationship space which is, at the same time, safe and secure, public and private: the proposed courtyard is created around children areas and meeting spaces among residents. The main court is secluded from the surrounding urban area, but open towards the dwellers; it's a "life box" on a child's scale whose base unit is replicable to create a new type of town.

The housing types are marked by three layers of gradual privacy: private layer (bedrooms, roof solarium "in the sunny sky"), intermediate layer (entry porch and terrace), relationship areas (main court); furthermore our homes are functional and practical with living area on the first floor (family's public space) and sleeping area on the second floor (family's private space), out of sight from street, outstretched to the court. Trees and plants will make the courtyard a peaceful place.

Unit type A = 1,864 sq.ft. Side Area = 10,000 sq.ft. Maximum height = 28 ft.
 Unit type B = 2,116 sq.ft. Building Covered Area = 3,985 sq.ft. Total Number of Units = 4
 Housing total area = 7,960 sq.ft. BCA/SA = 40%

groundwork sketch

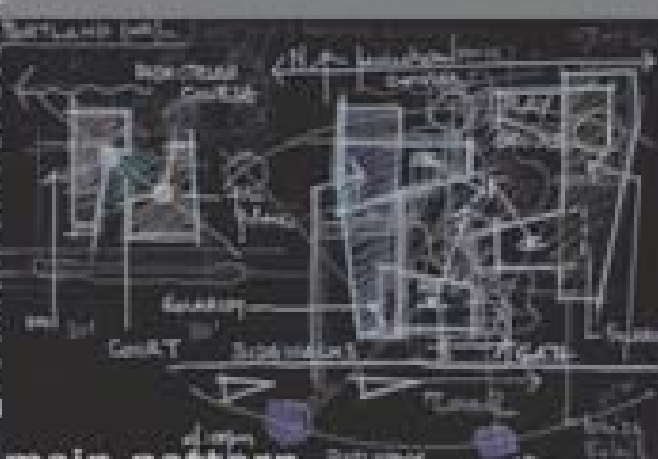

main pattern

- * courtyard housing as an attractive option for families with children
- * courtyard space as outdoor space for community interaction
- * courtyard space as a secure outdoor space to encourage children to play
- * housing type which ensures the family privacy but also a close watch on children
- * meeting and relax areas for neighbors

courtyard design development

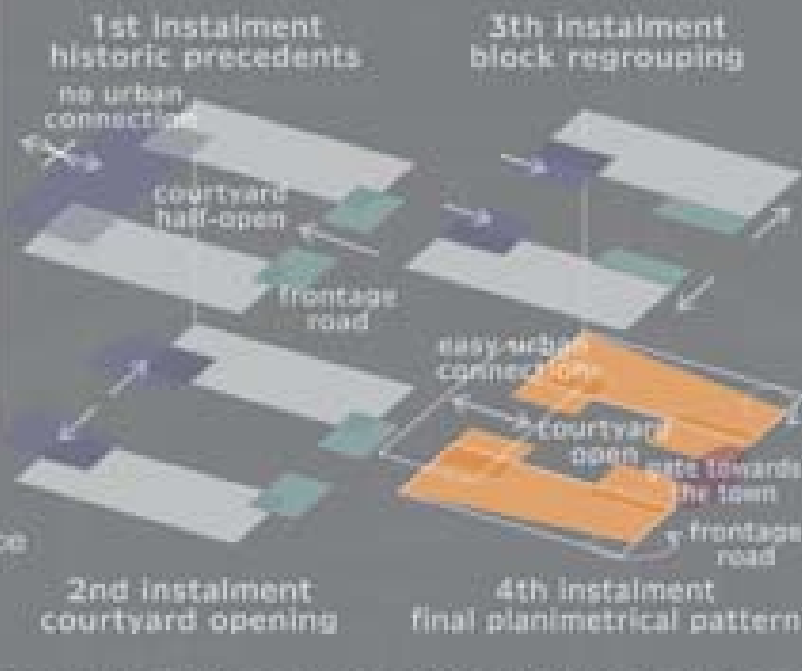

design principles and diagrams

as to-be-in-the-world
 urban space as "discovery place"
 meeting human beings and sharing common values
 orientation and identification
 (Christian Norberg-Schulze)

concept of dwelling



street elevation (east)



south elevation



courtyard elevation (south)

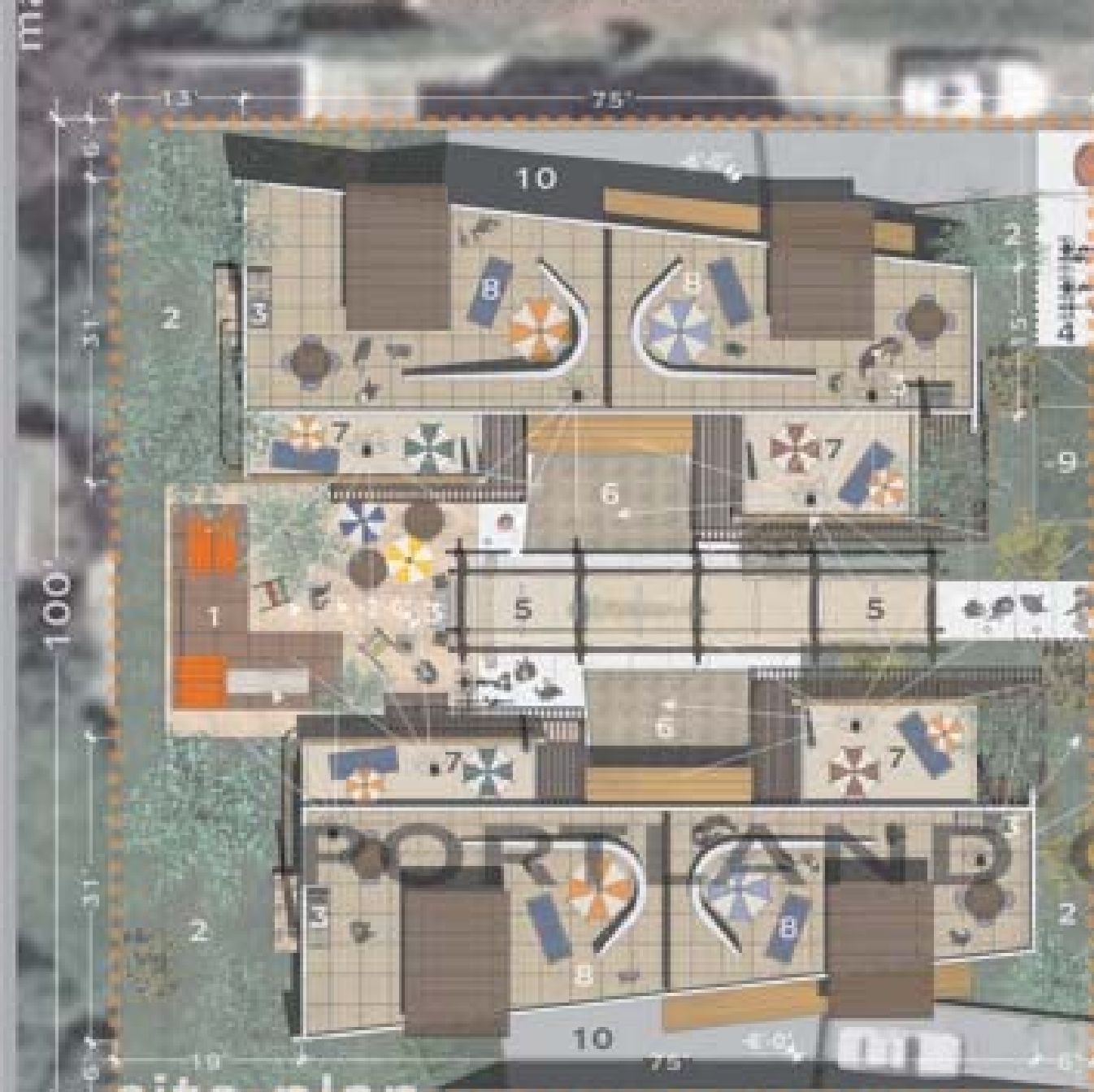
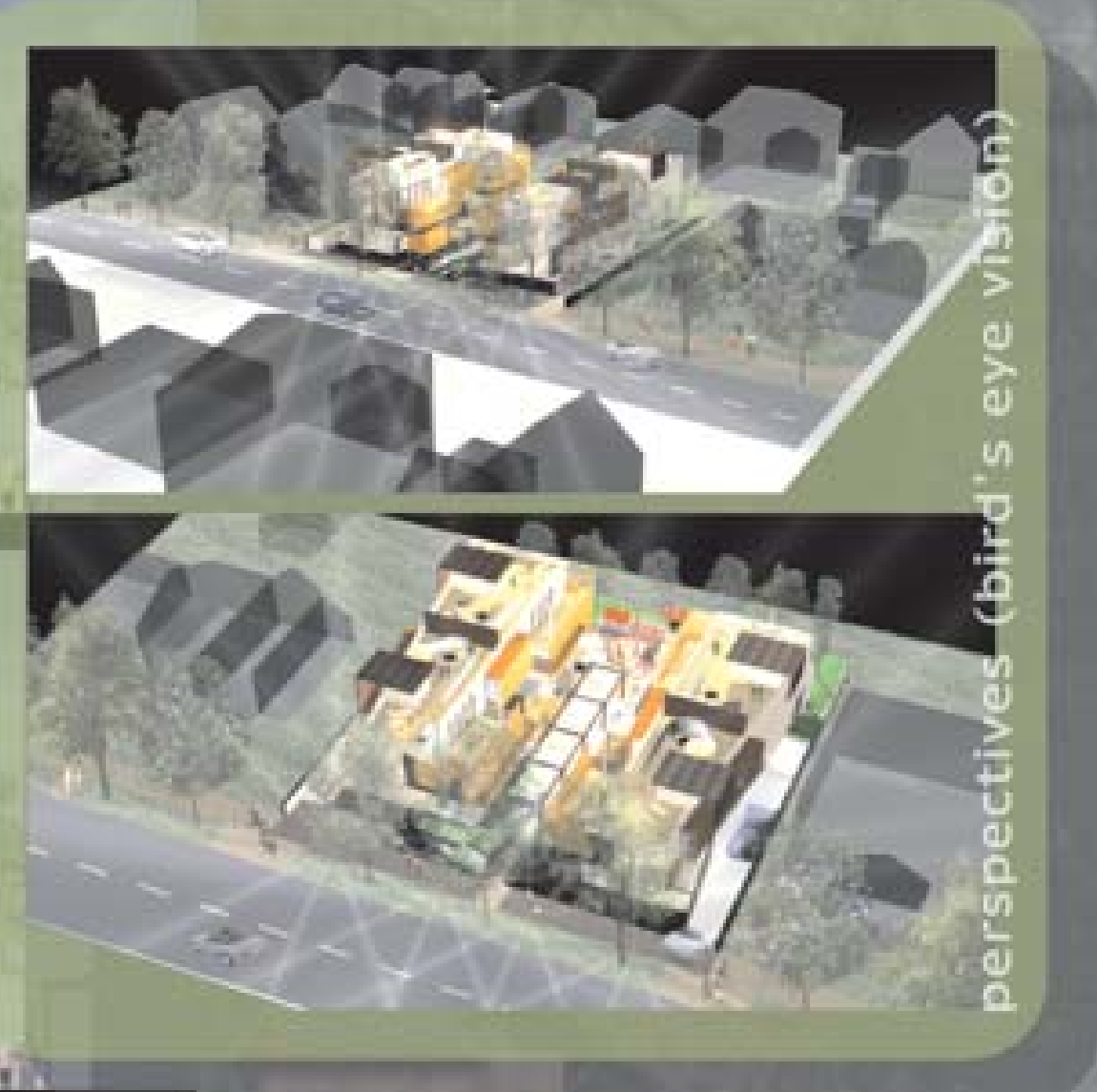

site plan

first floor plan



- site plan**
- 1. children play area
 - 2. private garden
 - 3. barbecue
 - 4. cycle rack
 - 5. covered arbor
 - 6. toddlers play area (sand)
 - 7. terrace
 - 8. solarium
 - 9. garbage boxes
 - 10. car area

- first floor**
- 1. dwellers meeting area
 - 2. safe and covered walk
 - 3. entry porch
 - 4. entry
 - 5. closet
 - 6. living
 - 7. dining
 - 8. kitchen
 - 9. laundry
 - 10. storage
 - 11. bath
 - 12. fireplace

R# 1076311225-rx

"NEW HOMES AROUND A HAPPY COMMUNAL SPACE"